

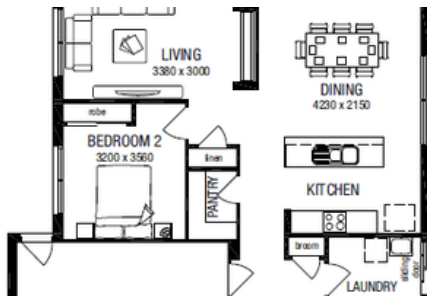

Lot 2504 Giri Way, Werribee



RARE OPPORTUNITY FOR TURNKEY H&L PACKAGE IN RIVERWALK ESTATE, CLOSE TO FREEWAY

Don't miss this fantastic opportunity in Riverwalk Estate in Werribee. Land set to title in October 2019. The block is perfectly positioned close to the Approved Primary School (set to open Jan 2020), Future Wetland and Park Reserve and minutes away from the Princess Freeway with easy access to Melbourne, Avalon Airport and Geelong.

This fantastic package is a turnkey 4 bed 2 bath double garage home built by Australia's leading home builder Metricon. Everything is included from fixed site costs to driveway, landscaping and fencing. Just move in and enjoy when complete!

Contact Yasmin 0425 688 004 or Nitesh 0413 471 820 today for more information.

Images are for illustrative purposes only. Actual facade and floor plan will be supplied on request.

The above information provided has been furnished to us by the vendor/s. We have not verified whether or not that information is accurate and do not have any belief in one way or the other in its accuracy. We do not accept any responsibility to any person for its accuracy and do no more than pass it on. All interested parties should make and rely upon their own inquiries in order to determine whether or not this information is in fact accurate.

🛏️ 4 🚿 2 🚗 2

Price	\$572,000
Property Type	residential
Property ID	121
Land Area	351 m2
Floor Area	209 m2

AGENT DETAILS

Yasmin Tordal - 0425 688 004
Nitesh Singh - 0413471820

OFFICE DETAILS

36 West Real Estate
3 Beachcomber PI Point Cook VIC
3030 Australia
0413 781 064

